

| APPLICATION CONDITIONS | MIN. | NOM. | MAX. |
|------------------------|------|------|------|
| TEMPERATURE (°F) | | | |
| PRESSURE (PSI) | | | |
| SPEED (SFPS) | | | |
| STROKE LENGTH (IN) | | | |
| CYCLE RATE (CYL/SEC) | | | |
| MEDIA | | | |

| BILL OF MATERIALS | | | | |
|-------------------|-----|-------|----------|-------------|
| ITEM | QTY | PART# | MATERIAL | DESCRIPTION |
| | | | | |
| | | | | |
| | | | | |
| | | | | |
| | | | | |
| | | | | |

| REVISIONS | | | | |
|-----------|------|-------------------------------------|-----------|-------|
| ZONE | REV. | DESCRIPTION | DATE | ECN # |
| 1 | A | ADDED BLANK NUMBER AND DIMENSIONS | 5/24/2018 | 8524 |
| 3 | B | UPDATED FOR BETTER SPRING RETENTION | 4/26/2021 | 1426 |
| 4 | C | ADDED NOSE RADIUS | 7/19/2021 | 1719 |

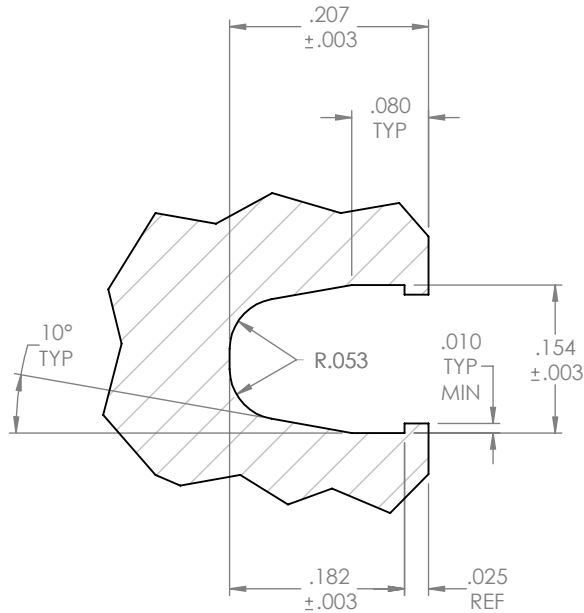

300V GROOVE

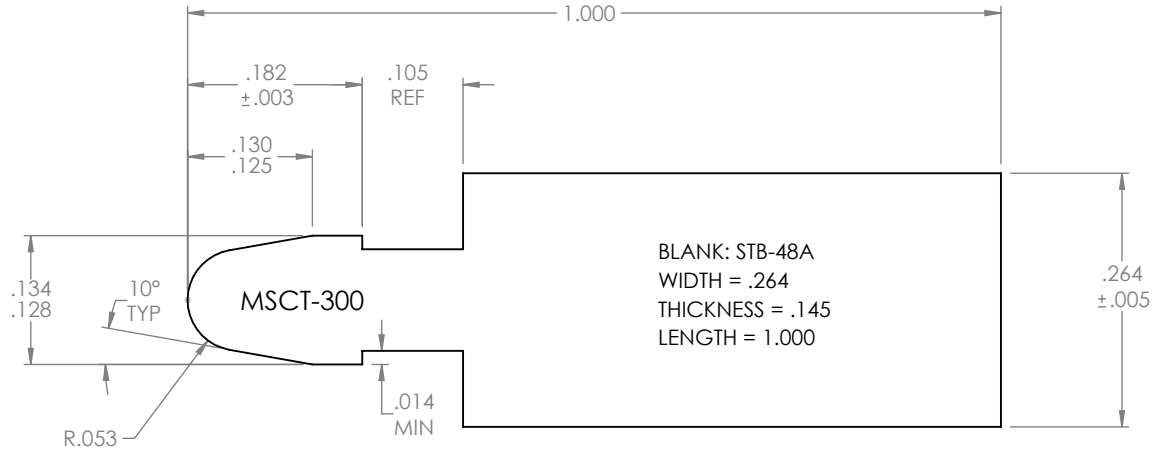

BLANK: STB-48A
WIDTH = .264
THICKNESS = .145
LENGTH = 1.000



PROPRIETARY AND CONFIDENTIAL
THE INFORMATION CONTAINED IN THIS DRAWING IS THE SOLE PROPERTY OF MW INDUSTRIES, INC. ANY REPRODUCTION IN PART OR AS A WHOLE WITHOUT THE WRITTEN PERMISSION OF MW INDUSTRIES, INC IS PROHIBITED.

| UNLESS OTHERWISE SPECIFIED: | | NAME | DATE |
|-----------------------------|--|------------|---------------------|
| DIMENSIONS ARE IN INCHES | | DRAWN | L. DOUGLAS 11/28/17 |
| TOLERANCES: | | MFG REVIEW | |
| FRACTIONAL ± 1/16" | | ENG APPR. | 11/28/17 |
| ANGULAR: ± .5° | | | |
| TWO PLACE DECIMAL ±.01 | | | |
| THREE PLACE DECIMAL ±.005 | | | |
| JACKET MATERIAL: | | COMMENTS: | |
| SPRING TYPE: 300 V-SPRING | | | |
| O-RING: | | | |
| DO NOT SCALE DRAWING | | | |



TITLE:
GENERAL ARRANGEMENT
300 V-SPRING
GROOVE AND TOOL

| SIZE | DWG. NO. | REV |
|------------|----------|--------------|
| A | MSCT-300 | C |
| SCALE: NTS | | SHEET 1 OF 1 |